

## Central Bedfordshire Council

### TRAFFIC MANAGEMENT MEETING

26 MARCH 2019

Clayhall Road, Kensworth

---

**Report of:** Paul Mason, Assistant Director, Highways  
(Paul.Mason@centralbedfordshire.gov.uk)

**Responsible Officer(s):** Charlotte Dunham, Senior Highways Officer, Highways  
(Charlotte.Dunham3@centralbedfordshire.gov.uk)

---

### Purpose of this report

To report on the proposals for Clayhall Road, Kensworth outside the side entrance of Kensworth Lower School.

### RECOMMENDATIONS

The Traffic Management Meeting is asked to:

1. **Approve the implementation of the 40mph buffer.**
2. **Approve the implementation of the No Waiting Restrictions.**
3. **Approve the traffic calming features but postpone the implementation until funding can become available at a later date**

## Overview and Scrutiny Comments/Recommendations

1. Not to be presented at Overview and Scrutiny.

### Issues

### Background Information

2. A request was made by Kensworth Lower School to the Highways Team for action concerning parking arrangements at school drop off and pick up times on Clayhall Road at the rear entrance/exit to the school.
3. The school entrance/exit in Clayhall Road is the second entrance into the school, the other is on Common Road where there are School Keep Clear markings and a layby area providing spaces for three or four cars to park and drop and collect children.
4. Many children walk into school from the village using this entrance on Common Road.

### ATC Data

5. Automated Traffic Count data collected over a 7-day period is the source of data collection used for Engineering purposes. Loops were placed within the 30mph limit in Clayhall Road outside the school entrance and showed the below.

ATC Data (MPH)		
	Mean	85th %ile
North Bound	33	40.9
South Bound	32.7	39.1

### Scheme Proposal

6. Having reviewed the site and instructed Road Engineers from Ringway Jacobs who visited the site and reviewed the data a scheme has been proposed to address the initial enquiry regarding parking and also speeds outside the school.
7. In summary the scheme elements that were consulted are to:
  - a. Install 2x raised tables or humps on Clayhall Road
  - b. Install No Waiting at Any Time restrictions on the junction of Common Road
  - c. Install a 40mph buffer zone on Clayhall Road, before entering the 30mph limit

8. The initial request from the school was to address parking issues at the entrance. Clayhall Road has recently had a small section of footway constructed, on the south western side, from close to the 30mph limit / Nation Speed Limit change to assist with walking to school and those being dropped off at school. Previously there was no footpath available.

### **Statutory Consultation**

9. Proposals were advertised in November/December for 21 days on the 3 elements of the scheme. Bedfordshire Police were consulted as were other emergency services. Bedfordshire Police raised no objections or comments to any of the proposals.

10. A number of representations were received from other parties.

### **Options for consideration**

11. Comments submitted as part of the consultation are as follows:

- i. Traffic Calming is needed in Common Road
- ii. Parking restrictions do not go far enough and need to go over the school entrance
- iii. Double yellow lines need to go both sides of the road from Common Rd/Lynch Hill for 350m. This is the only answer.
- iv. Traffic has increased and large vehicles using Clay Hall Road turn on the grass near the school in Clayhall Road as they cannot get through
- v. There is no merit in traffic calming, the area is congested at school times and speeds are low.
- vi. The 40mph zone should be extended to include all the properties on Clayhall Road

### **Reason/s for decision**

12. Officer responses to the comments made are as follows:

- i. This scheme was to address issues on Clayhall Road as raised.
- ii. Junction protection on Clayhall Rod/Common Road was proposed as providing any type of restrictions spanning a wider area of Clayhall Road would prevent anyone dropping/collecting children. Common Road is the B4540 and already has School Keep Clear markings preventing congestion at peak times. Having observed Clayhall Road at school times parking is generally orderly and considered a more suitable place to stop than on B4540. Should the school provide details of a travel plan we may take the opportunity to review at a later date.
- iii. Another element of the scheme which is not subject to statutory consultation is to install a H bar across the school access. We can investigate installing additional H bars over accesses.
- iv. No evidence of vehicles carrying out U turns on the verge was found.

- v. Traffic calming features were proposed by Road Engineers upon reviewing the date, which shows speeds over a 24hr period, for 7 days.
- vi. The scheme was to look at the area in the vicinity of the school on Clayhall Road and a short section of buffer prior to the existing 30mph proposed, this was not a route analysis of the entire section and therefore this request falls outside of the scope of the scheme. When considering alterations to speed limits, DFT Guidance 01/13 'Setting Local Speed Limits' is used to ensure a consistent approach across the network.

### **Reason for urgency**

- 13. The scheme proposes to address parking issues on the junction of Clayhall Road and Common Road to maintain visibility at peak times.
- 14. A 40mph buffer may assist in bringing down speeds prior to the 30mph limit.
- 15. The tables will be a suitable method of further reducing speeds at a later date, when budget becomes available.

### **Council Priorities**

- 16. The scheme meets objective J – Reduce the risk of people being killed or seriously injured.

### **Corporate Implications**

- 17. None

### **Legal Implications**

- 18. The TROs will need sealing before enforcement on site.

### **Financial and Risk Implications**

- 19. Completion of design and on-site construction for any elements will be funded from the Integrated Transport Capital Works Programmed 2019/20.

### **Equalities Implications**

- 20. Notices were displayed on site, in the local press as per Statutory Consultation criteria and anyone affected by the proposals were invited to make comments.

### **Conclusion and next Steps**

- 21. The design should be finalised for the buffer and waiting restrictions. A Target Cost will need to be agreed before works take place in Q2/3 2019/20.

22. The implementation of the proposed traffic calming, be revisited at a later date when budget becomes available, should the site still warrant the installation.

**Appendices**

**Appendix A: Request for Action Submission**

**Appendix B: Speed Data**

**Appendix C: Site Notices**

**Appendix D: Drawing**

**Appendix E: Police Response**

**Appendix F: Representations**

**Report Author:**

Charlotte Dunham – Senior Highways Officer, Highways

[Charlotte.Dunham3@centralbedfordshire.gov.uk](mailto:Charlotte.Dunham3@centralbedfordshire.gov.uk)

## Appendix A



**KENSWORTH CHURCH of ENGLAND ACADEMY**

**Common Road, Kensworth, Bedfordshire, LU6 3RH**

**Telephone 01582 872336**

**E-mail: [kensworth@cbc.beds.sch.uk](mailto:kensworth@cbc.beds.sch.uk)**

22<sup>nd</sup> May 2018

Kevin Collins, Ward Councillor  
Richard Stay, Ward Councillor  
Paul Salmon, Central Bedfordshire Council

Dear Sirs

**SUBJECT: Road safety in Clayhall Road alongside Kensworth Church of England Academy**

We are writing to request assistance with road safety in Clayhall Road. This is where we have the main entrance into the school car park and many of our parents use this way to enter and exit the school at the start and end of each school day.

At the moment there are no restrictions signs or line markings so parents park right up to the school gate. This makes it extremely hazardous for staff and visitors using the car park. Exit is particularly dangerous as you can't see around the parked cars so you pull out onto the road completely blind and onto the opposite side of the road. Should a car be coming, then there is no room for manoeuvre because of the parked cars.

We have recently received several complaints from two of our neighbours who are regularly having cars parked across their drives. On approaching parents, they have received aggressive and rude responses.

We repeatedly ask our parents to park away from the gates and not to block anyone's drives. However, this is not having any effect and is hard to enforce when there is no "legal" signage or markings.

Highways put in a new pathway alongside the school perimeter in Clayhall Road just over a year ago and we were told that parking restrictions in the form of road markings would follow. Nothing further has happened. Our contact at the time was Emma Kines. We have approached her again and understand the matter was referred to Transportation and it will be a couple more months until we might hear anything. We have also made representations to Pat Mitchell on the Parish Council.

We would like to request site inspections at start and end of school day so that you can witness the hazardous situations that occur. We are extremely keen to see some means of enforcement/restrictions in place as soon as possible for the safety of pupils and adults.

**Interim Headteacher**

DIOCESE OF  
**ST ALBANS**



Appendix B

Report ID	Site	Direction	Start Date	End Date	Posted Speed Limit (PSL)	Total Vehicles	Mean Speed	85%ile Speed	(24 Hour) 5 Day Ave	(12 Hour) 7 Day Ave	(24 Hour) 7 Day Ave	%age HGVs
Site	Clay Hall Road (75m south of lynch hill), Kensworth	Northbound	Sat 16 Jun 2018	Fri 22 Jun 2018	30mph	3601	33.0	40.9	478	437	514	0.38%
Site	Clay Hall Road (75m south of lynch hill), Kensworth	Southbound	Sat 16 Jun 2018	Fri 22 Jun 2018	30mph	5003	32.7	39.1	715	619	715	0.22%

Schedule
Sat 16 Jun 2018
Sun 17 Jun 2018
Mon 18 Jun 2018
Tue 19 Jun 2018
Wed 20 Jun 2018
Thu 21 Jun 2018
Fri 22 Jun 2018

# PUBLIC NOTICE

The logo for Central Bedfordshire Council, featuring a green circle with the text "Central Bedfordshire" in white.

### CENTRAL BEDFORDSHIRE COUNCIL PROPOSES TO INTRODUCE 40MPH SPEED LIMIT IN CLAY HALL ROAD, KENSWORTH

Reason for proposal: The speed limit is part of a road safety scheme and is being promoted in combination with other speed reducing measures.

Effect of the Order:

To introduce a 40mph Speed Limit on the following lengths of road in Kensworth:-

1. Clay Hall Road, from a point approximately 200 metres south from its junction with Lynch Hill extending in a southerly direction for approximately 100 metres.

Further Details may be viewed online at [www.centralbedfordshire.gov.uk/publicstatutorynotices](http://www.centralbedfordshire.gov.uk/publicstatutorynotices).

Comments should be sent in writing to the Traffic Management team at the address below or e-mail [traffic.consultation@centralbedfordshire.gov.uk](mailto:traffic.consultation@centralbedfordshire.gov.uk) by 20<sup>th</sup> December 2018. Any objections must state the grounds on which they are made.

Order Title If made will be "Central Bedfordshire Council Clay Hall Road, Kensworth 40mph Speed Limit Order 2018"

Central Bedfordshire Council  
Priory House  
Chicksands  
Shefford SG17 5TQ

Marcel Coiffait  
Director of Community Services

29<sup>th</sup> November 2018



# PUBLIC NOTICE

The logo for Central Bedfordshire Council, featuring a green circle with the text "Central Bedfordshire" inside.

## **CENTRAL BEDFORDSHIRE COUNCIL PROPOSES TO INSTALL TRAFFIC CALMING MEASURES IN CLAY HALL ROAD, KENSWORTH**

Notice is hereby given that Central Bedfordshire Council, in exercise of its powers under Section 90 A-I of the Highways Act 1980 and all other enabling powers, propose to construct Speed Humps on Clay Hall Road, Kensworth. These proposals are part of a scheme to reduce traffic speeds and create a safer environment for all road users.

**Speed Humps at a nominal height of 75mm are proposed to be sited at the following location in Kensworth:-**

1. Clay Hall Road, at a point approximately 60 metres, south of its junction with Lynch Hill.
2. Clay Hall Road, at a point approximately 180 metres, south of its junction with Lynch Hill.

Further Details may be viewed online at [www.centralbedfordshire.gov.uk/publicstatutorynotices](http://www.centralbedfordshire.gov.uk/publicstatutorynotices).

Comments should be sent in writing to the Traffic Management team at the address below or e-mail [traffic.consultation@centralbedfordshire.gov.uk](mailto:traffic.consultation@centralbedfordshire.gov.uk) by 13<sup>th</sup> December 2018.

Central Bedfordshire Council  
Priory House  
Chicksands  
Shefford SG17 5TQ

Marcel Coiffait  
Director of Community Services

22<sup>nd</sup> November 2018

# PUBLIC NOTICE



## CENTRAL BEDFORDSHIRE COUNCIL PROPOSES TO INTRODUCE NO WAITING AT ANY TIME CLAY HALL ROAD, KENSWORTH

Reason for proposal: For avoiding danger to persons or other traffic and/or for preventing the likelihood of any such danger arising;

Effect of the Order:

To introduce No Waiting at any time, on the following length of road in Kensworth:-

1. Clay Hall Road, both sides, from it's junction with Lynch Hill extending approximately 15 metres in a southerly direction.

Further Details may be viewed online at [www.centralbedfordshire.gov.uk/publicstatutorynotices](http://www.centralbedfordshire.gov.uk/publicstatutorynotices).

Comments should be sent in writing to the Traffic Management team at the address below or e-mail [traffic.consultation@centralbedfordshire.gov.uk](mailto:traffic.consultation@centralbedfordshire.gov.uk) by 13<sup>th</sup> December 2018. Any objections must state the grounds on which they are made.

Order Title: If made will be "Central Bedfordshire Council (Bedfordshire County Council (District of South Bedfordshire) (Civil Enforcement Area and Special Enforcement Area) (Waiting Restrictions and Street Parking Places) (Consolidation) Order 2008) (Variation No.\*) Order 201\*\*"

Central Bedfordshire Council  
Priory House  
Chicksands  
Shefford SG17 5TQ

Marcel Coiffait  
Director of Community Services

22<sup>nd</sup> November 2018

## Appendix D:

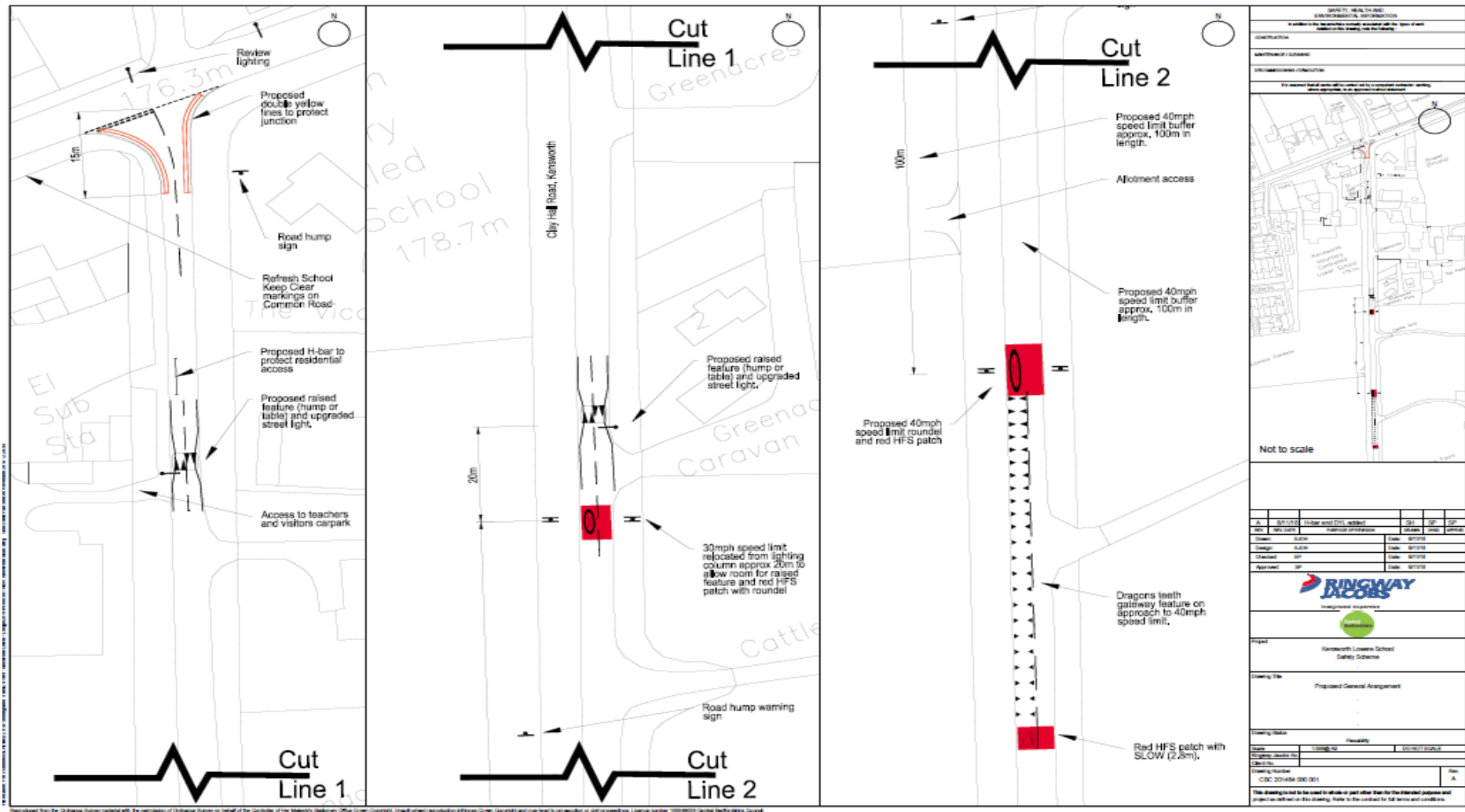

## Appendix E:

Central  
Bedfordshire



### Proposed Traffic Calming and Waiting Restrictions, Clay Hall Road, Kensworth

<p>This Authority has considered the proposals as outlined in your e-mail and offer the following comments for further consideration.</p> <p>Comments</p>	
<p>This Authority has considered the proposals as outlined in your e-mail and attachments dated the 19<sup>th</sup> November 2018 together with the reason given. The proposed traffic calming features and waiting restrictions are accepted by this authority, therefore no objection will be offered.</p>	<p>X</p>

Name: - ... **Stephen Welham.**

Address Traffic Management Office,  
Traffic Management Unit,  
Bedfordshire, Cambridgeshire & Hertfordshire Road Policing Unit,  
Joint Protective Services,  
Halsey Road,  
Kempston, Beds.  
MK42 8AX.

Signed:- ..... S. P. Welham

20<sup>th</sup> November 2018

## Appendix F:

Good morning

I refer to the proposals to introduce a [40 mph](#) speed limit and other traffic management measures on Clay Hall Rd, Kensworth.

The measures are intended to improve highway safety outside a school and for that reason these measures are fully supported.

Regards

Richard

**Councillor Richard Stay**

**Central Bedfordshire Council**

Mob: 07795 181550

Mail: [Richard.stay@centralbedfordshire.gov.uk](mailto:Richard.stay@centralbedfordshire.gov.uk)

Blog: [Richard-Stay.blogspot.co.uk](http://Richard-Stay.blogspot.co.uk)

Twitter: [@staycc](#)

Priory House, Monks Walk, Chicksands, Shefford, Beds, SG17 5TQ

*Conservative Councillor for: Caddington, Hyde, Kensworth, Slip End, Studham & Whipsnade*

Information security classification\* of this email – UNCLASSIFIED

\*Information security classifications

OFFICIAL – Loss could cause some damage to the Authority

OFFICIAL – SENSITIVE – Loss could cause severe damage to the Authority

UNCLASSIFIED – Loss would cause little or no damage to the Authority

---

Hello

We have been passed details of the proposed traffic calming measures for Clayhall Road outside our school. Whilst we welcome these measures, we still feel they do not go far enough.

We would prefer to see "no parking" restrictions either side of the entrance to our school car park. Entrance to and from the car park is exceptionally hazardous when cars are parked either side of the gate as you have to pull out into the road completely blind. You have no visibility whatsoever putting our staff, visitors, parents and pupils at great risk. Whilst the proposed measures may calm the speed of the traffic, it will not remove the risk factor.

We would still wish to see speed bumps or speed restrictions on Common Road immediately alongside the school. We understood that this was to be a consideration once the new motorway link road was opened and Common Road could be detrunked. There is no mention of this in the consultation. Please can we have an update. We are anxious to ensure the safety of our pupils, parents and staff who walk along this stretch at all times.

Kind regards.



---

26th November 2018.

(1)

Dear Sirs

Reference your letter referring to traffic calming measures in Clayhall Rd.

Having lived in Clayhall Rd for 63 yrs and seen how the traffic has increased in volume and speed. Your proposed measures won't make any difference. The first thing that needs to happen is double yellow lines, both sides of the road from Common road up Clayhall road for 350 metres. To stop teachers, school staff and parents leaving their cars from the junction of Clayhall road and beyond the school, all day Monday to Friday. As you are probably aware the new developments in Studham has increased the traffic, lorries delivering aggregates and building materials to the new developments. Lorries removing earth and waste materials, Tankers sometimes running all day from Studham sewage works. Because they can't cope, also articulated lorries, coming from Hemel Hempstead road to get into Dinstable. Then there's farm traffic, which has increased in size and have difficulty getting past the parked cars without running on the grass verge.

With cars parked outside the school and down to the crossroads, traffic entering Clay-hall road from Common road comes to a stand still, as traffic coming from Studham are on the wrong side of the road, and then there's stalemate, nobody wants to reverse, and let the oncoming traffic pass.

(2)

Its difficult and dangerous to reverse into Common Rd,  
as its always busy,

Your suggested road calming will not make any difference,  
as its not addressing the real problem which is parking, for  
school staff and parents, The new footpath which has been  
constructed on the school side of Chayhall road has only increased,  
the problem as the carriageway is now narrower, and less room  
for passing vehicles,

My property has two entrances opposite the school, and some days  
due to parked cars, I cannot get out of my entrance without  
running on the grass verge,

The only answer is double yellow lines both sides of  
the road and proper parking facilities for school staff and  
parents, your thoughts and comments please.

Yours Sincerely .

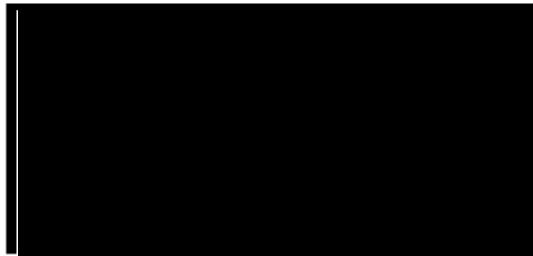



Dear Sir/Madam

I write in response to the statutory consultation regarding proposed traffic calming measures on Clay Hall Road in Kensworth. As a resident of Common Road in Kensworth and as a mother of three children, I was interested to see what measures the Council is proposing to deal with the traffic in our area.

In my view the proposed measures will have little effect on road safety in Kensworth. I use Clay Hall Road every day to drive my children to school in Markyate, and am aware that the junction with Common Road can become congested with Kensworth School parents parking along this stretch of road. However the necessity of navigating the parked cars means that there is very little potential for high speeds. Therefore while I support the waiting restrictions I see no benefit in the proposed traffic calming measures on Clay Hall Road.

By contrast, Common Road is used on a daily basis by non-residents circumventing Dunstable's traffic with no respect for the 30 mph speed limit in Kensworth. I live close to Dovehouse Lane and by the time cars travelling from the direction of Whipsnade towards the A5 have reached this area, they are very clearly travelling well in excess of 30 mph and no doubt, by the time they reach the school at the other end of the village, they can easily be travelling at 45-50 mph. I know that residents have complained about the issue of cut-through traffic travelling at high speeds for many years and would encourage you to examine the evidence of the volunteers monitoring speeds from time to time, who no doubt will be in touch.

I cannot see any merit whatsoever in traffic calming measures on a comparatively quiet side road when the main road - along which all students who walk to school must pass and enter the school - is crying out for such measures. Rather than easing the plight of parents who, in this small village, choose to drive their children to school, surely it would be better to encourage more pedestrians, since this would further the Government's (and therefore the Council's) environmental and health agendas, by making the main road safer. Any type of traffic calming measure at the end of the village near the school would make an enormous difference to the overall safety of Common Road.

Yours sincerely

[REDACTED]

---

Dear Sir/Madam

I am responding to the public notice to introduce a 40 mph speed limit to a section of Clayhall Road.

I have lived a [REDACTED] in Clayhall Road for the last 8 years. This property sits right on the edge of the road. I am very much for the speed restriction that you are proposing. I am extremely surprised by the fact that you are not introducing this limit to the whole of this road right up to Oldhill Woods where it drops to 40mph already.

The section that you are at present going to leave as a 60 mph includes properties having driveways straight onto the road, blind bend ( in fact my neighbour takes there lives in there hand when they pull out as they are right on top of the blind bend and vehicles travelling at 60mph are upon them immediately), crossroads that should be designated a black spot due to the amount of accidents, a section that goes up hill into the woods in and out of sunlight with the potential of the wildlife that live in the woods eg large deer running out.

This section of road has horses, pushbikes, dog walkers, ramblers and slow moving wide agricultural vehicles using it throughout the year.

This would be the perfect opportunity to extend the proposed 40mph speed limit to give people a better chance of avoiding future incidents even fatalities.

I would welcome the opportunity to meet with you on site to discuss and show my concerns.

Kind Regards

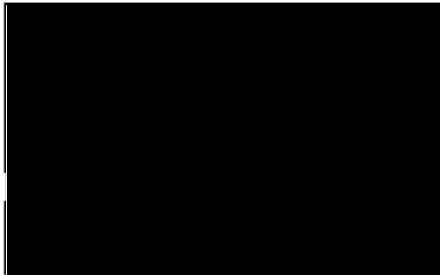

---

I am writing to you regarding the proposed traffic calming measures for Clayhall Road in Kensworth. I am a resident in Clayhall Road and welcome any traffic calming along our road but am concerned and disappointed that the measures you are proposing do not go far enough to safeguard the residents of this road and fall short of what is required to make this road safer.

[REDACTED] Clayhall Road which is one of 8 houses that are located further south along Clayhall Road than the proposed new 40MPH speed limit.

We, along with our neighbours find the current 60MPH speed limit along this stretch of road to be very dangerous for exiting our properties, our house is between a low visibility dip in the road and a blind bend and cannot understand why the 40MPH is not being extended to us and beyond to the junction of Buckwood Lane, where the speed limit changes to 40MPH.

It is not safe to have residents in a 60MPH speed limit, we have had numerous near misses with cars speeding around the bend while trying to exit our drive.

It is a road that is used by speeding cars, alongside agricultural vehicles, large amounts of cyclists and horses. There have been numerous accidents at the crossroads of Clayhall Road and Buckwood lane as cars speed out of the 40MPH limit towards Lynch Hill.

If the speed limit is changed to 40MPH as proposed and we are not included in that, we will sit in a 60MPH stretch of road wedged either side of a 40MPH limit, this surely does not make sense.

I would like you to reconsider and as stated above welcome the changes but please can you extend the 40MPH limit all the way to the junction of Buckwood lane, thus eliminating any 60MPH limits along this road.

We feel we have been overlooked in the traffic calming measures which is not treating us fairly alongside other residents who will benefit from the changes.

Kind Regards|

[REDACTED]

---